

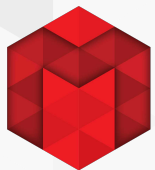

- 1: Wood Stud Frame
- 2: Exterior Sheathing
- 3: StoGuard Mesh and Sto Gold Fill Joint Reinforcement
- 4: Sto EmeraldCoat
- 5: ArmorWall PB (R10, R15, and R21 Standard)
- 6: #14-13 Self Tapping Screw
- 7: StoGuard Mesh and Sto Base Coat Joint Reinforcement
- 8: Base Coat: Sto Primer/Adhesive-B or Sto approved alternate
- 9: Primer: StoPrime Sand or Sto Approved Alternate
- 10: Finish Coat: Stolit Lotusan 1.0 or Sto approved alternate
- 11: ArmorWall PB Integrated Drainage Plane (reverse side of panel)

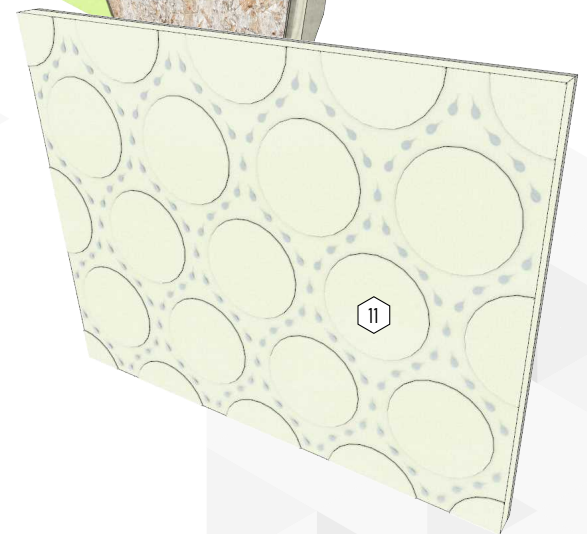

1-844-MAX4YOU
 (1-844-629-4968)
www.maxlifeindustries.com

Mail To:
 MaxLife Industries
 P.O. Box 2128
 Salisbury, NC 28145

MAXLIFE
 INDUSTRIES
 INNOVATING THE
 BUILDING ENCLOSURE

Ship To:
 4995 South Main Street
 Salisbury, North Carolina 28147

DETAIL:
 STOQUIK SILVER DRAINSCREEN ON ARMORWALL PB TO WOOD STUD
 FRAME FIELD OF WALL

SCALE:
 NTS

REVISION:
 01

NOTES:
 - FOLLOW STUCCO SYSTEM MANUFACTURER INSTALLATION GUIDELINES